

LEGEND/INDEX:			
S.S.L.	-- STRUCTURAL SLAB LEVEL.	STRP.	-- STIRRUP
CJ	-- CONSTRUCTION JOINT.	TYP.	-- TYPICAL
L.O.E.J.	-- LINE OF EXPANSION JOINT.	MC	-- MULLION COLUMN
REINF.	-- REINFORCEMENT.	PC	-- PARAPET COLUMN
SECT.	-- SECTION.	PC	-- PLAIN CEMENT CONCRETE / MASS CONCRETE / UNREINFORCED CONCRETE
DET.	-- DETAIL.	UNO	-- UNLESS NOTED OTHERWISE
SC	-- STUB COLUMN	F.G.L.	-- FINISHED GROUND LEVEL/PAVEMENT LEVEL
AAC	-- AUTOCLAVED AREATED CONCRETE BLOCK	CST	-- COLUMN STOPS AT THIS LEVEL
BW	-- BURNT BRICK MASONARY.	F.F.L.	-- FINISHED FLOOR LEVEL (AS PER ARCHITECTURAL DRAWING).
BW	-- BOTHWAYS.		

- NOTE:
- 1) GRADE OF CONCRETE FOR FOOTINGS-M25
 - 2) GRADE OF CONCRETE FOR COLUMN & PEDESTAL-M25
 - 3) GRADE OF STEEL-Fe550D
 - 4) CLEAR COVER FOR COLUMNS -40MM
 - 5) CLEAR COVER FOR FOOTINGS -50MM

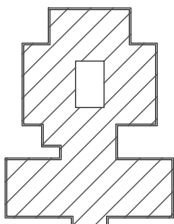

KEY PLAN :

VERIFIED BY

DY. MANAGER-PROJECT
GT&TC

MANAGER-PROJECT
GT&TC

CLIENT :

GOVT. TOOL ROOM AND TRAINING CENTRE
RAJAJINAGAR INDUSTRIAL ESTATE,
BANGALORE-560010

PROJECT:

ESTABLISHMENT OF NEW GTTC CENTRE AT SINDHANOOR
IN RAICHUR DISTRICT.

CONSULTANTS:

NC NAVEEN CONSULTANTS
ARCHITECTS & ENGINEERING CONSULTANTS
#1308,2nd floor,2nd Cross,Ashoka Nagar
(Behind B.M.S.Engineering College Hostel)
Bangalore : 560050.
Ph:080-26620836/37 Fax: 26620836
Email: naveenconsultants@gmail.com,
naveenconsultants1@gmail.com

FOR NOTES AND SPECIFICATION REFER
DRAWING No
NC/STR/N4/Job.No/2022(V)/GTTC- SINDHANOOR/GN&GD/01&01A

TITLE: STAFF QUARTERS & GIRLS HOSTEL

DRAWING:
WALL FOUNDATION, GRADE AND
PLINTH BEAM LAYOUT

DRAWN BY : GSR DATE : 14/10/2025

DESIGN BY : MEP SCALE : NTS

CHECKED BY: KVNS SHEET : A2

DWG NO: SQ & GH -04

RELEASED FOR: Preliminary Drawing Tender Information Only For Approval For Construction